

Assembly instructions 03/2021

TOOLS:

socket wrench 13 mm for M8 hexagon nut

Please assemble the table on a soft surface (e.g. a carpet or blanket) to avoid damages.

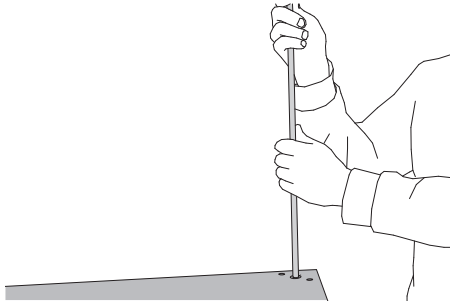

1. Place the table top upside down on a blanket and screw in the threaded rod.

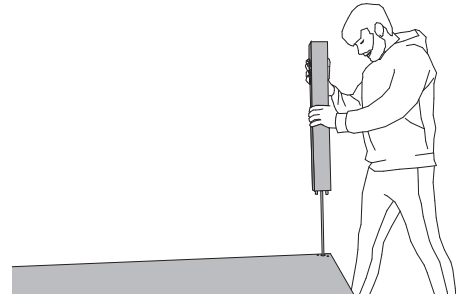

2. Place the table leg on the threaded rod.

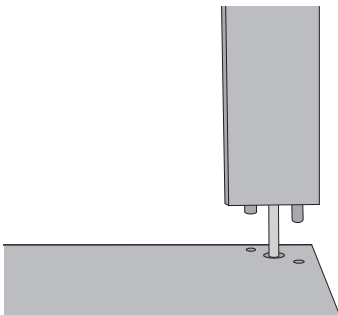

3. Place the leg on the table top and insert the dowel pins into the holes.

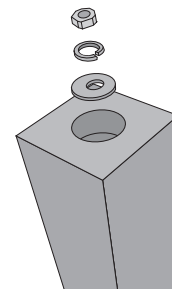

4. Place flat washer, spring washer and screw nut.

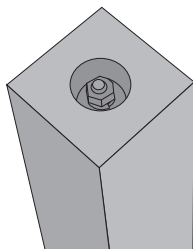

5. Screw in the screw nut.

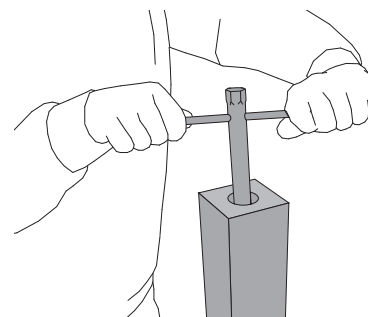

6. Tighten the screw nut using a socket wrench.